



RURAL MUNICIPALITY OF DUFFERIN

By-Law No. 1947

Being a by-law of the Rural Municipality of Dufferin amending the existing Provincial Road Reserve.

WHEREAS subsection 168(1) of The Municipal Act provides as follows:

“A council may by by-Law establish reserve funds for any general or specific purpose”;

AND WHEREAS in 1992 the Province of Manitoba transferred 2 miles of Provincial Road 338 to the Rural Municipality of Dufferin as per the attached map as Schedule “A” north of Provincial Road 305;

AND WHEREAS the balance of \$4,897.43 is remaining to spend on the original 2 miles of Provincial Road 338 north of Provincial Road 305;

AND WHEREAS the Province of Manitoba is transferring 6 miles of Provincial Road 338, with exception to the Provincial Bridge on Road 35W between Sections 30 and 29-6-6 WPM, to the Rural Municipality of Dufferin as per the attached map as Schedule “A” between Provincial Road 305 to Provincial Road 245;

AND WHEREAS the Provincial Government is providing a one-time compensation grant from the Province of Manitoba to the Rural Municipality of Dufferin in the amount of \$49,950.00, being 6 miles of road at \$8,325.00 per mile, and payable as follows:

\$49,950.00 payable March 31, 2015;

AND WHEREAS the Provincial Government is providing a one-time grant from the Province of Manitoba to the Rural Municipality of Dufferin culverts up to the value of \$10,050.00;

AND WHEREAS the Provincial Government is providing a one-time abandonment grant from the Province of Manitoba to the Rural Municipality of Dufferin in the amount of \$28,968.18, being 9.656 kilometers of road at \$3,000.00 per kilometer, and payable as follows:

\$28,968.18 payable prior to September 30, 2016;

AND WHEREAS the Rural Municipality of Dufferin deems it to be in the best interest of the municipality to create a reserve to be referred to as the “Provincial Road Reserve”;

NOW THEREFORE BE IT ENACTED as a by-law of the Rural Municipality of Dufferin;

1. That a Provincial Road Reserve Fund be and hereby is created;
2. That the sum of \$49,950.00 be deposited into the Provincial Road Reserve in the year 2015 and \$28,968.18 be deposited into the Provincial Road Reserve in the year 2016.
3. That the funds in this reserve shall be expended for the maintenance and construction of the Provincial Road 338 transferred as per the attached map and the funds shall be expended as determined by Schedule "B" as attached, which may be amended by resolution of council.
4. That the Rural Municipality of Dufferin shall keep both in its books, a separate account designating the purpose for which the fund was created and showing at all times that state of the Reserve Funds created hereby.
5. That if the reserve fund or any portion thereof is invested; the securities therefrom shall be earmarked and kept separate from other securities of the Rural Municipality of Dufferin.

THAT By-law No. 1629 is hereby repealed.

DONE AND PASSED by the Council of the Rural Municipality of Dufferin, in open session, duly assembled, in Carman, Manitoba this 19th day of May, 2015.

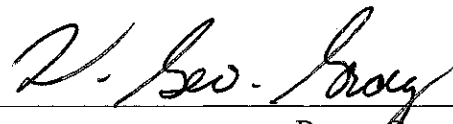

Reeve George Gray

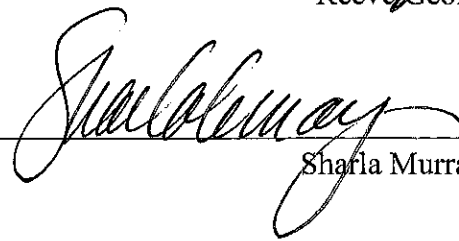

Shafla Murray, CAO

Read a first time this 21st day of April, 2015.

Read a second time this 19th day of May, 2015.

Read a third time this 19th day of May, 2015.

Schedule "A"

MUN. OF DUFFERIN

PROVINCE OF MANITOBA
HIGHWAYS DEPARTMENT
DESIGN OFFICE
WPG., OCT., 1969



SCALE: 1 in. = 3 miles

REVISED
OCTOBER 24, 1991

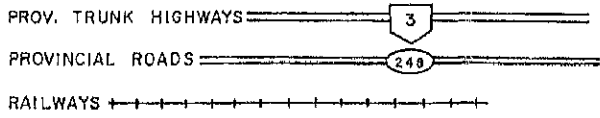
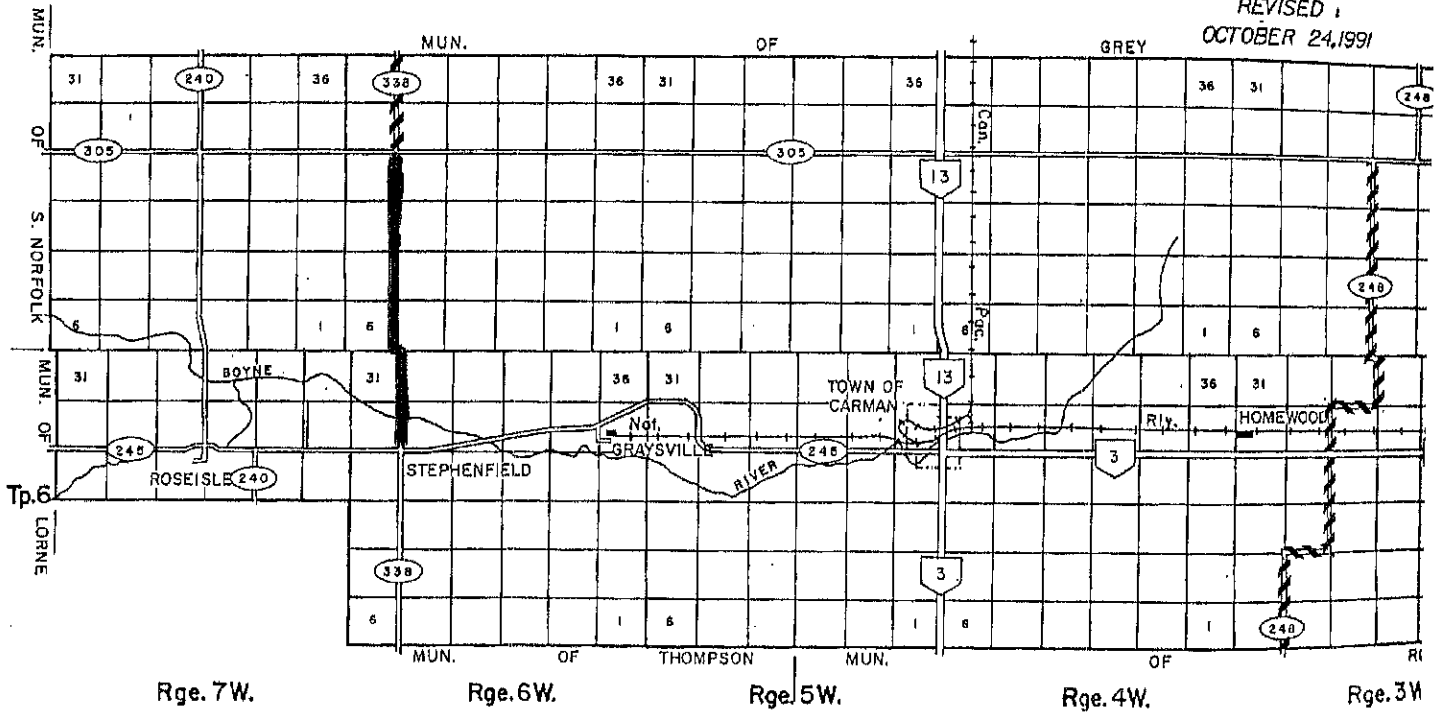

Schedule "B" to By-Law #1947 Provincial Road Reserve

Rural Municipality of Dufferin

Description of the Proposed Maintenance and Construction - the funds in this reserve shall be expended for the maintenance and construction of the Provincial Road 338 transferred as per Schedule "A" between Provincial Road 305 to Provincial Road 245;

- a) **Maintenance on old portion** – to maintain the 2 miles of Road the maintenance gravel would be 160 yards of gravel for each mile to be gravelled every year; E of 33 & 28-6-7 WPM.
- b) **Maintenance on new portion** – to maintain the 6 miles of Road the maintenance gravel would be 200 yards of gravel for each mile to be gravelled every year; E of 30 & 31-6-6 and E of 6, 7, 18 & 19-7-6.

Sharla Murray, CMMA

Chief Administrative Officer

April 21st, 2015